

# PRETREATMENT FOR RAIN GARDENS



## RAMIFICATIONS OF FAILED PRETREATMENT

- CLOGGING REDUCES INFILTRATION CAPACITY
- DEBRIS BUILD UP IN CURB-CUT CAN CAUSE BYPASS BEFORE THE GARDEN IS FULL
- SEDIMENT IN GARDEN IS UNSIGHTLY AND SMOTHERS PLANTS

1318 MCKAY DR. NE, SUITE 300  
HAM LAKE, MN 55304  
(763) 434-2030 (M-F 8:00-4:30)  
WWW.ANOKASWCD.ORG



## COMMON PRETREATMENT PROBLEMS

TURF FILTER STRIPS ARE OFTEN INEFFECTIVE, REQUIRING EXHAUSTIVE RAKING AND ANNUAL SOD REPLACEMENT.



ROCK INLET EFFECTIVENESS DIMINISHES RAPIDLY WITHOUT FREQUENT LABOR INTENSIVE CLEANING.



ALTERNATIVE PRETREATMENT CHAMBERS CAN BE COST PROHIBITIVE AND MAY FAIL, FLOODING THE GARDEN WITH DEBRIS AND REQUIRING HOURS TO CLEAN.



## SOLUTION: RAIN GUARDIAN™ PRETREATMENT CHAMBER

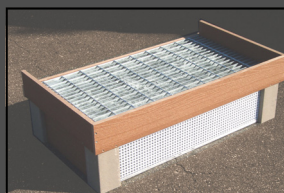
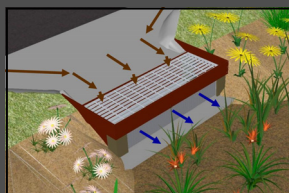
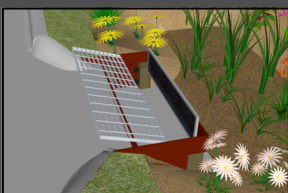

REFER TO RAIN GUARDIAN™ PRETREATMENT CHAMBER FLYER FOR DETAILS





# PRETREATMENT FOR BIORETENTION

Rain Gardens • Swales • Filtration Basins • Infiltration Basins

## RAIN GUARDIAN FOXHOLE

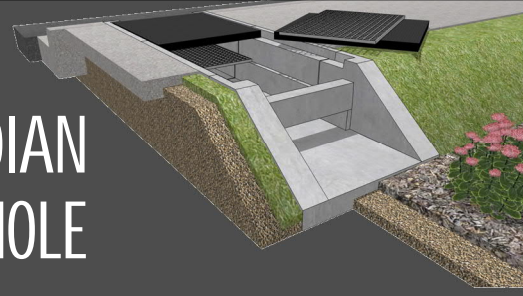

### Rain Guardian Benefits

- Maximize capacity and extend effective life
- Grate/filter/chamber combination captures sediment and debris
- Overflow points prevent inlet debris from causing bypass before bioretention reaches capacity

- Simplify maintenance
  - Sediment and debris removed from chamber with shovel
  - Drop-in filter cleaned with broom or hose
- Easy installation
  - Placement and securing take only minutes
  - New construction or retrofits

*"A Rain Guardian is a must for any rain garden."*  
- Steve M., St. Paul, MN



### Foxhole-Specific Functionality

- Route runoff under sidewalks or other paths to bioretention areas
- Effective pretreatment concealed under sidewalk outside of bioretention area

*"The Rain Guardians provide very effective pretreatment along with efficient, simplified maintenance."*  
- Noah Czech, City of St. Cloud, MN



### Design Components

- Load-bearing lid conceals accumulated debris
- Modular design accommodates varying lengths in 3' increments
- Lightweight lid and grate for easy maintenance
- Bolt-down composite lid and fiberglass grate deter theft

*"It's amazing, with just a 0.5" rain event each Rain Guardian captured two 5 gallon buckets full of sediment. Maintenance is simple and can be accomplished in only minutes..."*  
- Brian Sanoski, Wright SWCD

## Rain Guardian—Foxhole

### Standard exterior dimensions:

Inlet: 32.25"L x 35"W x 19"H  
Middle: 36.5"L x 35"W x 19"H  
Outlet: 30"L x 35"W x 19"H

Distributed by Porous Technologies LLC:  
(CA, OR, WA, NV, AZ, NM)

**POROUS**  
TECHNOLOGIES, LLC  
*When it Rains...it's Porous™*

